

## At-Risk Instructions

The plan for those who choose to sit in the **AT-RISK SECTIONS** is the following:

### PARKING

- Parking for AT-RISK is in the SOUTH PARKING LOT.
- We will have this area coned off, along with SRT members at designated locations.

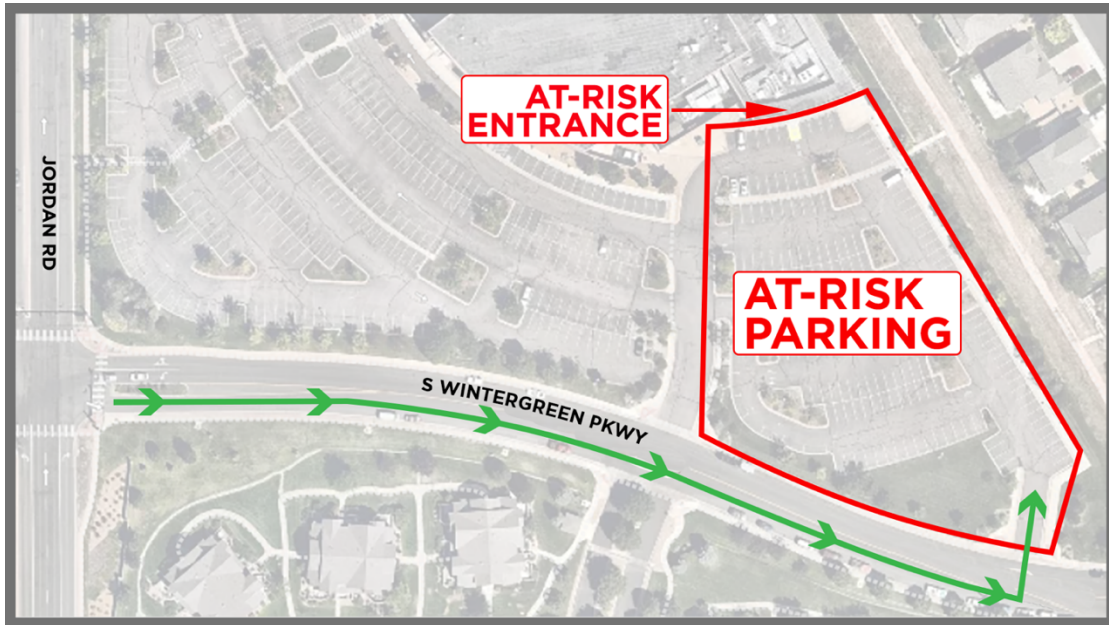

### ENTRANCE/EXIT

- The Entrance/Exit for AT-RISK attendees will be through the South Doors. We will not allow any other individuals to enter through this door.
- Two ushers and an SRT member will be stationed at the door.
- AT-RISK attendees will also use the backstage hallway to enter into the Worship Center.
- During the service, the doors leading into the backstage hallway will be closed. AT-RISK attendees will be able to use the Tunnel closest to their section.
- After the service, AT-RISK attendees will exit into the backstage hallway and leave the church through the South Doors.

**NOTE:** If AT-RISK attendees enter through the Main Entrance, ushers will escort them to their chairs.

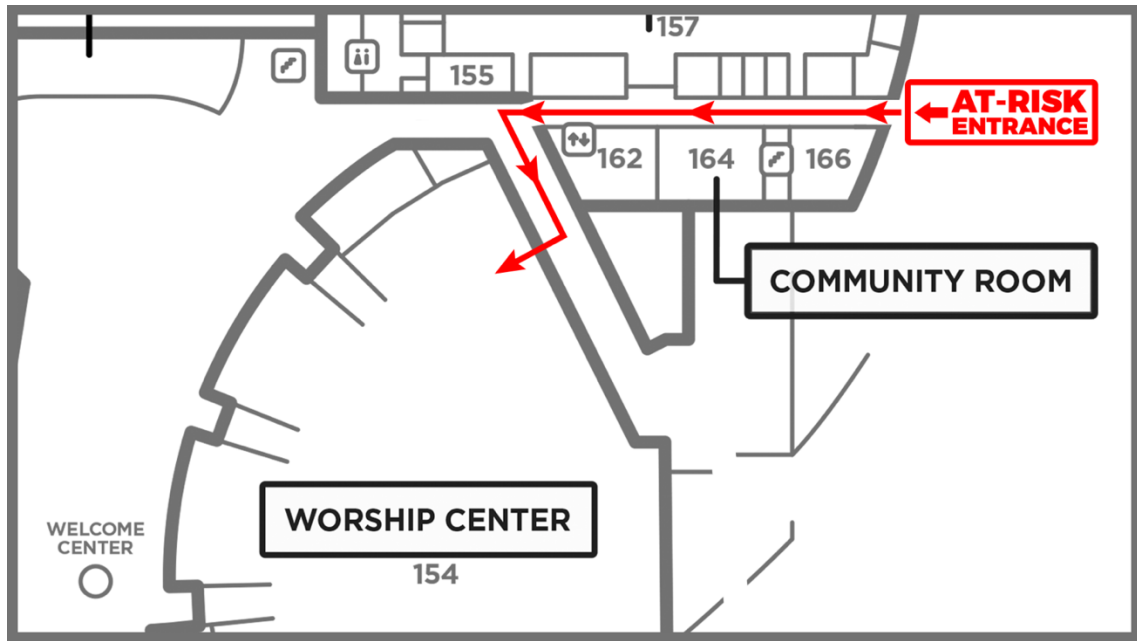

#### AT-RISK SECTION

- Sections A, B, F, & G will be designated for AT-RISK attendees. We will first open up Sections B & G. Once those are filled, we will open up Sections A & F.

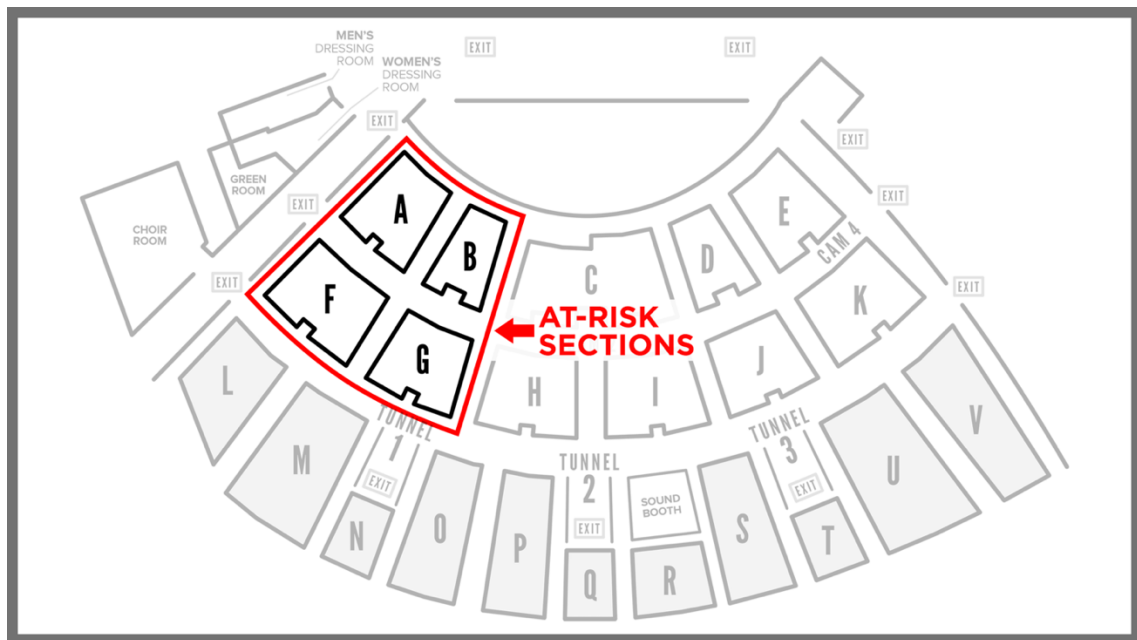

#### RESTROOMS

- We will not have any designated Restrooms for AT-RISK attendees.